

**UPRERAPRJ13055**



**AMAATRA CRYSTAL**

**Digi  
Homes**  
TECHNOLOGY DRIVEN HOMES

**COMMITTED TO EXCELLENCE**

Jaipuria Sunrise Township, NH-24, Opp. Manipal Hospital, Ghaziabad (UP)



# COMPANY PROFILE

## ABOUT AMAATRA CRYSTAL

- **Amaatra CRYSTAL** is a Joint venture Project of **AMAATRA GROUP** and **SB GROUP**.
- **Amaatra Crystal** is an upcoming Residential Project placed at Plot No. GH-02, Jaipuria Sunrise Township, NH 24, Ghaziabad (UP) which includes all the facilities and amenities.
- The Project offers 2BHK, 3BHK, 4BHK and Duplex Apartments with the sizes ranging from 1045 Sq.ft. to 2525 Sq.ft. available for all residential buyers.
- The Township spreads over 22.5 acres of land with lots of green area and a superlative design.
- **Amaatra Crystal** is ably led by Mr. Mahender Bansal, Mr. Rajesh Chopra, Mr. Rupesh Agarwal & Mr. Mukesh Agarwal with decades of experience in real estate industry.

## VISION OF AMAATRA GROUP

**Daring visions for uniquely inspiring projects...**

- Our vision is to enhance value for investment of the customer by providing unique quality oriented project at best of the location.

## MISSION OF AMAATRA GROUP

**Our mission is to 'transcend the expected'...**

- To build world class real estate concepts with highest standards of ethics, professionalism and quality. To explore diverse areas of growth within the field of construction and encompassing entire gamut of residential, commercial and retail complexes".



# HOME AUTOMATION



**Automation of all Bedrooms**



**Curtain Automation\***



**Main Door Lock Automation\***



**Motion Sensor in Washrooms and Kitchen**



\* Applicable on certain category of flats



**AMAATRA CRYSTAL**  
Opp. Manipal Hospital NH-24, Ghaziabad



# AMENITIES



**PARK**



**JOGGING TRACK**



**SWIMMING POOL**



**KID'S PLAY AREA**



**CLUB**





**AMAATRA CRYSTAL**  
Opp. Manipal Hospital NH-24, Ghaziabad



# TOWNSHIP LAYOUT

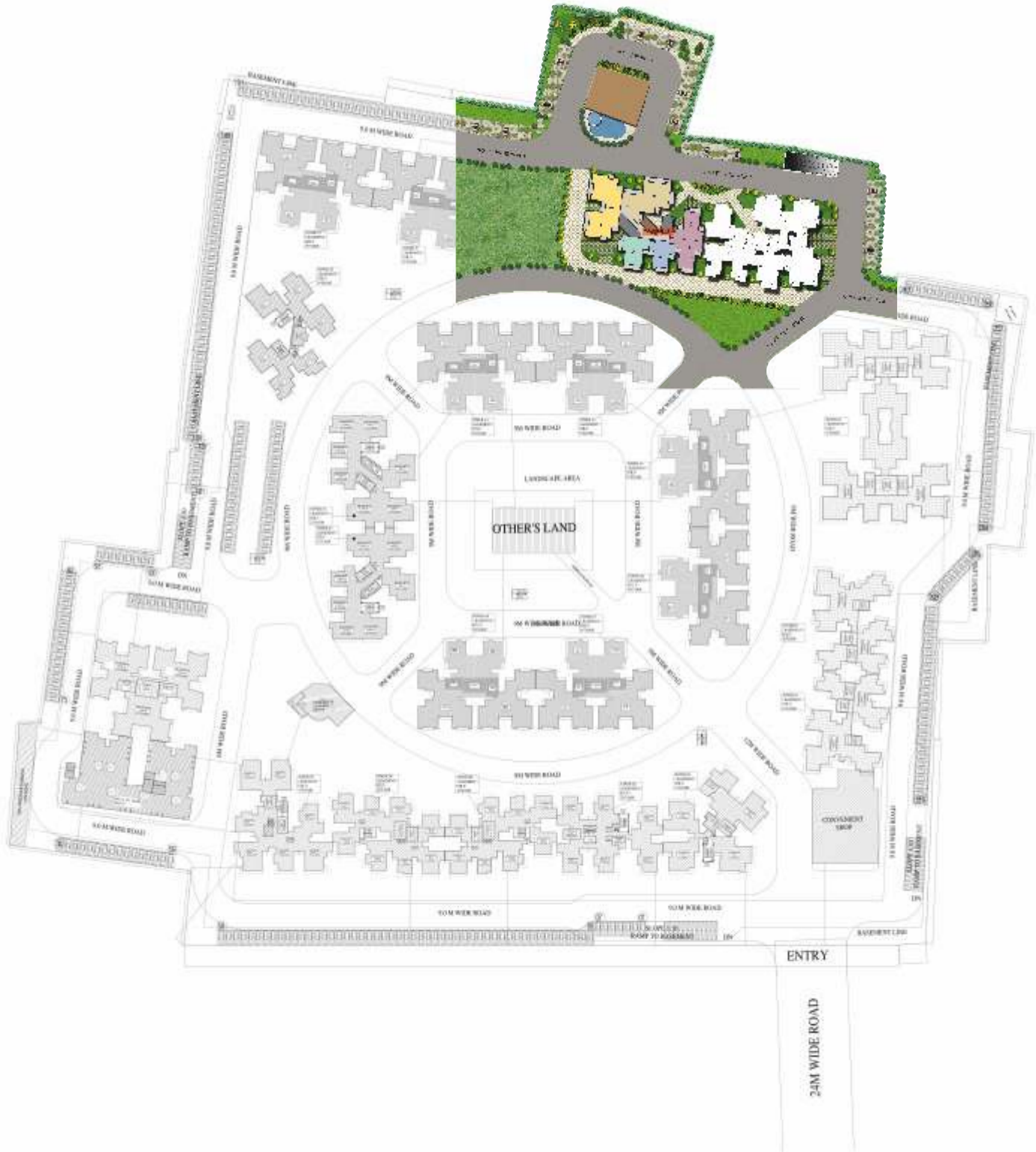



**AMAATRA CRYSTAL**  
Opp. Manipal Hospital NH-24, Ghaziabad

**Digi Homes**  
TECHNOLOGY DRIVEN HOMES

# SITE PLAN



1	1145 Sq. Ft.	2 BHK+2 TOILET
2	1045 Sq. Ft.	2 BHK+2 TOILET
3	1322 Sq. Ft.	3 BHK COMPACT
4 & 5	1600 Sq. Ft.	3 BHK+3 TOILET
6	2525 Sq. Ft.	4 BHK+4 TOILET+SER. ROOM
7	2290 Sq. Ft.	4 BHK+4 TOILET+STORE (Duplex)



# FLOOR PLAN

Unit - 6



**2525 SQFT (234.58 SQMT)**  
**4 BHK + 4 TOILET + SERVANT ROOM**

Particular	Sq. Mtr.	Sq. Ft.
Builtup Area	166.31	1790.16
Carpet Area	126.21	1358.52
Balcony Area	32.1	345.52

# FLOOR PLAN

## DUPLEX UNIT NO.-07



## LOWER FLOOR PLAN



# FLOOR PLAN

DUPLEX UNIT NO.-07



**2290 SQFT (152.185 SQMT)**  
**4 BHK + 4 TOILET + 2 DRESS**

## UPPER FLOOR PLAN

Particular	Sq. Mtr.	Sq. Ft.
Builtup Area	152	1635.57
Carpent Area	118.32	1273.14
Balcony Area	21.74	233.92

# FLOOR PLAN

Unit - 4 & 5



**1600 SQFT (148.64 SQMT)**  
**3 BHK + 3 TOILET**

Particular	Sq. Mtr.	Sq. Ft.
Builtup Area	103.71	1116.33
Carpet Area	79.15	851.97
Balcony Area	17.05	183.53



# FLOOR PLAN

Unit - 3



▲  
**ENTRY**

**1322 SQFT (122.82 SQMT)  
3 BHK COMPACT**

Particular	Sq. Mtr.	Sq. Ft.
Builtup Area	87.17	938.30
Carpet Area	65.02	699.88
Balcony Area	16.13	173.62

# FLOOR PLAN

Unit -1



▲  
**ENTRY**

**1145 SQFT (106.37 SQMT)**  
**2 BHK + 2 TOILET**

Particular	Sq. Mtr.	Sq. Ft.
Builtup Area	75.69	814.73
Carpet Area	59.07	635.83
Balcony Area	10.69	115.07



# FLOOR PLAN

Unit - 2



▲  
ENTRY

**1045 SQFT (97.08 SQMT)**  
**2 BHK + 2 TOILET**

Particular	Sq. Mtr.	Sq. Ft.
Builtup Area	70.27	756.39
Carpet Area	54.36	585.13
Balcony Area	10.58	113.88



**AMAATRA CRYSTAL**  
Opp. Manipal Hospital NH-24, Ghaziabad



# CLUSTER PLAN

## TOWER - S1



1	1145 Sq. Ft.	2 BHK+2 TOILET
2	1045 Sq. Ft.	2 BHK+2 TOILET
3	1322 Sq. Ft.	3 BHK COMPACT
4 & 5	1600 Sq. Ft.	3 BHK+3 TOILET
6	2525 Sq. Ft.	4 BHK+4 TOILET+SER. ROOM
7	2290 Sq. Ft.	4 BHK+4 TOILET+STORE (Duplex)



# SPECIFICATIONS

## LIVING/DINING/BEDROOMS

Walls/Ceiling	Smooth Paint Finish and One highlighted wall with Paint OR Wallpaper, POP Cornice
Floors	Vitrified Tiles (4x2 size for Duplex only)
Doors	Both Side Laminated Flush door with Hard Wood Frame
Balcony Door	Aluminum Powder Coated Glazed/UPVC

## TOILETS

Walls/Ceiling	Ceramic Water Proofed Tiles up to 7ft ht.
Floor	Anti-Skid Ceramic Tiles
Doors	Both Side Laminated Flush door with Hard Wood Frame
Windows	Aluminum Powder Coated Glazed/UPVC
Sanitary Ware	Provision for Hot & Cold Water System and White/off-white Chinaware with Superior Brand like Somany/Hindware/Parryware or equivalent with CP fittings.
Water Proofing	Water Proofing with Superior Grade Material

## UTILITY BALCONY/BALCONY

Floor	Anti-Skid Ceramic Tiles
Water Proofing	Water Proofing with Superior Grade Material
Doors	Aluminum Powder Coated Glazed/UPVC
Walls/Ceiling	Water Proof Exterior Paint with pleasing Shade

## ELECTRICAL

FRLS Copper Wiring in Concealed PVC Conduits. Modular Electric Switches Brand Anchor/Havells/Le grand or equivalent. Provision for TV, AC Points & Power Points.

## SUPER STRUCTURE

Earthquake resistant structure designed against static and dynamic forces under seismic conditions. 100% RCC Construction using Aluminium Formwork technology (MIVAN TECHNOLOGY)

## KITCHEN

Amenities	Individual RO system, Working Platform with Granite top and stainless steel sink.
Wall/Ceiling	2ft ht Wall Tiles above Counter
Floor	Anti-Skid ceramic tiles/Vitrified Tiles
Windows	Aluminum Powder Coated Glazed/UPVC

## MASTER BEDROOM

Walls/Ceiling	Smooth Paint Finish and One highlighted wall with Paint OR Wallpaper, POP Cornice.
Floor	Wooden flooring/Vitrified flooring/Wooden texture Vitrified Tiles
Doors	Both Side Laminated Flush door with Hard Wood Frame

## ENTRANCE LOBBY

Premium Entrance Lobby with Waiting Lounge

## DUPLEX STAIRCASE

Stainless Steel railing with Toughened Glass work



**AMAATRA CRYSTAL**  
Opp. Manipal Hospital NH-24, Ghaziabad



# DELIVERED PROJECT

**Amaatra Homes, Sector-10, Greater Noida West**



- **The project spreads over 5 acres of land with lot of green area and absolute fantastic design with podium concept.**
- **Total Number of Flats in Project is 926.**
- **All towers Occupation Certificate received and Almost 400+ registry has been done.**
- **Amaatra Homes is excellently built and designed by best of the architect.**





- **The Project Amaatra Homes Noida offers exclusive features like natural light and cross ventilation in all apartments, swimming pool, park and garden, separate walking track, security, fire fighting system, sports facilities, gym, club house, power back and 24 hours water supply.**
- **The project covers CCTV camera at all common access points.**
- **Well managed basement parking.**

## LOCATION MAP



MAP NOT TO SCALE





**AMAATRA CRYSTAL**  
Opp. Manipal Hospital NH-24, Ghaziabad

**Digi  
Homes**  
TECHNOLOGY DRIVEN HOMES





**Corporate & Site Office:**

Plot No. GH-02, Jaipuria Sunrise Township, NH-24, Opp. Manipal Hospital, Ghaziabad (UP)

**Email:** [sales@amaatragroup.com](mailto:sales@amaatragroup.com), **Website:** [www.amaatragroup.com](http://www.amaatragroup.com)

**Toll Free No.: 1800 103 4240**